

Assembly Instructions:

1. Remove contents out of the box.
2. Locate cage assembly depicted in Fig. 1
3. Remove rear cage from front cage by grabbing the cage handles (7) with both hands. Place both thumbs on left and right Filtration locks (16) apply pressure outwards to the cage handles (7) until the rear cage detaches as depicted in Fig. 2.
4. Clean all contents excluding the filter pack. Refer to OSHA Cleaning Instructions following guidelines as outlined by OSHA (in 29 CFR 1910.134).
5. Wash Hands Before handling the cleaned contents and filtration material in a sterile environment also outlined by OSHA (in 29 CFR 1910.134).
6. Place Front cage (3) flat on sanitized work surface as depicted in Fig. 3.
7. Take one filter sheet out from the filtration pack. Store remaining filter replacements in a secure sterile environment to minimize the risk of cross-contamination.
8. Place Filter flat on the back of the Front Cage as depicted in Fig. 3. (IMPORTANT! Ensure the smooth side of filter is facing your mouth before locking in place.)
9. Secure filter by snapping in the Rear Cage. Make sure the Filtration Keys align with the Filtration locks. Carefully push raised end of rear cage until you hear an audible click. This secures all three contents in place and completes the construction of the Cage Assembly.
10. Locate Fastener Holes(9) on the Dual Head Strap(5). Stretch the Fastener Hole over the Fastener Prong(8). (Holes on both sides of the Dual Head Strap(5) must align).

11. Rotate Dual Head Strap (5) upwards as depicted in Fig.4
12. Connect Mask Housing (4) to Cage Assembly by using top and bottom Mask housing alignment prongs (14)(15) and Cage Alignment holes (10)(11) as depicted in Fig.4. (Note: Wide Tab (13) on the bottom side and Short Tab (12) on top)

13. Move onto fitting instruction steps

FITTING INSTRUCTIONS:

Must be followed each time face mask is worn

1. Place the assembled mask over the mouth and nose, then pull the dual head strap over the crown of the head as depicted in Fig.5.
2. Ensure the head strap adequately secures the mask to your face but remains loosely fitted. The mask is not intended to be tight or create a vacuum seal.
3. Once properly fitted, the user can remove excess strap material by cutting the Dual head band strap as close to the alignment hole as possible.

FILTER REFILL INSTRUCTIONS:

1. Remove mask housing from cage assembly.
2. Remove dull head band from cage assembly
3. With the open end and rear cage facing down on a table: grab the cage handles(7) with both hands. Place both thumbs on left and right Filtration locks(16) apply pressure outwards to the cage handles(7) until the rear cage detaches as depicted in Fig. 2.
4. Discard used filter and repeat OSHA Cleaning Instructions before replacing the new filter

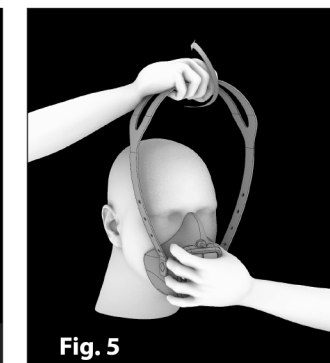
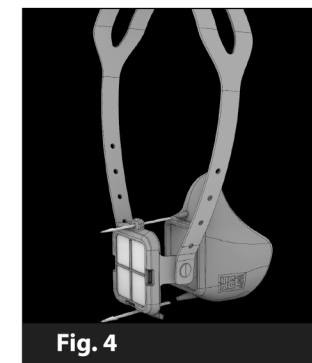
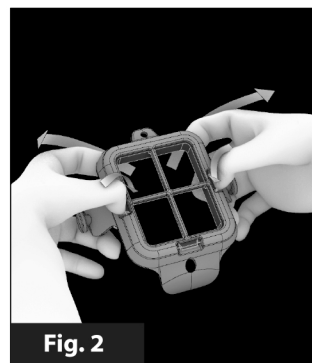
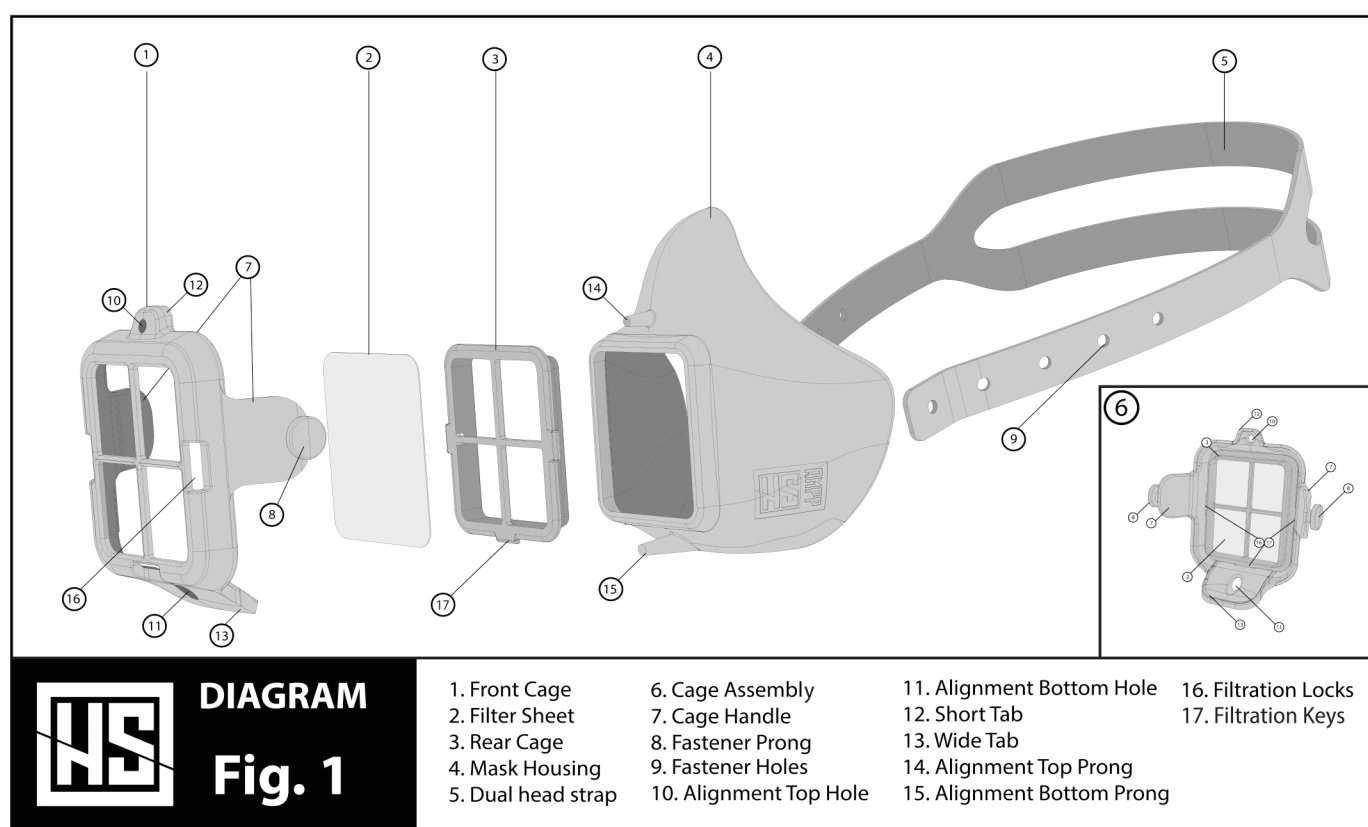

FOR MORE INFORMATION

and assistance with the AMPP Surgical Mask or to report an adverse event, please contact us at
Made in U.S.A. with U.S. materials by
Home Land Sourcing LLC
450 fort argyle Rd. Savannah, GA 31419
www.Ampmask.com/ampp-information

